**SH7500R****pH ANALYZER****OUTLINE**

The SH7500R is a digital pH analyzer in 96 x 96 DIN size case and has large-sized display excellent in visibility. Enhanced design allowed automatic buffer calibration, communication interface, and wide range of power input voltage.

The functions are available for various applications in the field.

FEATURES

- SIMPLE OPERATION
- EXTRA-LARGE DIGITAL DISPLAY
- COMPACT SIZE IN 96 x 96 MM DIN CASE
- AUTOMATIC BUFFER CALIBRATION
- EVENT OUTPUTS STANDARD
- COMMUNICATION INTERFACE
- WIDE RANGE OF POWER INPUT VOLTAGE
- SELF DIAGNOSTICS

**SPECIFICATIONS**

Input: Glass electrode, Antimony electrode(pH) or ORP electrode(ORP)

Input range: 0 ~ 14pH or -1.500 ~ 1.500V (ORP)

Output range: Programmable, 4pH in span min. (0.5V at ORP) 1pH increment (0.1V at ORP)

Output: 4 ~ 20mA DC isolated, 600Ω max.

Display: 4 digits, 7 segments LED, dual

Linearity: ± 0.03pH (± 3mV)

Repeatability: ± 0.01pH

Alarm: Up to 4 high or low alarms

Number of set points: 4 max.

Set point range: 0 ~ 14pH (-1.5 ~ 1.5V)

Output relay: Form-A, 250VAC 0.5A

Hysteresis adjustment: 0 ~ 14pH (-1.5 ~ 1.5V)

ON delay timer: 0 ~ 600 sec.

Diagnostics output: 1 Form-A, 250VAC 0.5A

Self diagnostics: Low pH -0.50pH and below, high pH

(Error detection) 14.50pH and above, low temp. -25°C and below, high temp. 150°C and above, buffer standard and compensation curve

Temperature compensation: 0 ~ 100°C

Temp.sensor: Pt1000 (standard)

500Ω, 6.8kΩ, 10kΩ, 20kΩ

Buffer calibration: JIS pH standard solution, auto-calibration or manual-calibration

Output hold: Programmable, at output, alarm contact and error contact

Shift function: 0.01 pH increments within ± 1.5pH
0.1°C increments within ± 5.0°C

Case structure: IP65 (only front panel)

Operation conditions: -10 ~ 50°C, 90%RH max.

Power supply voltage: 85 ~ 264VAC. 45 ~ 65Hz

Power consumption: 6VA @ 100VAC

Weight: Approx. 0.5 kg

OPTION

Communication interface module: RS-232C or RS-422A

Rate: 9600, 4800, 2400 1200, 600 or 300bps

Interrupter: 0 ~ 600 sec. replaces alarm 1 to 4

Operation: High or Low

Cycle time: 0 ~ 600 sec.

On time: 0 ~ 600 sec.

On delay timer: 0 ~ 600 sec.

Dust protection cover: Installed on rear terminal panel

PROBE & ANALYZER CONNECTION OVERVIEW

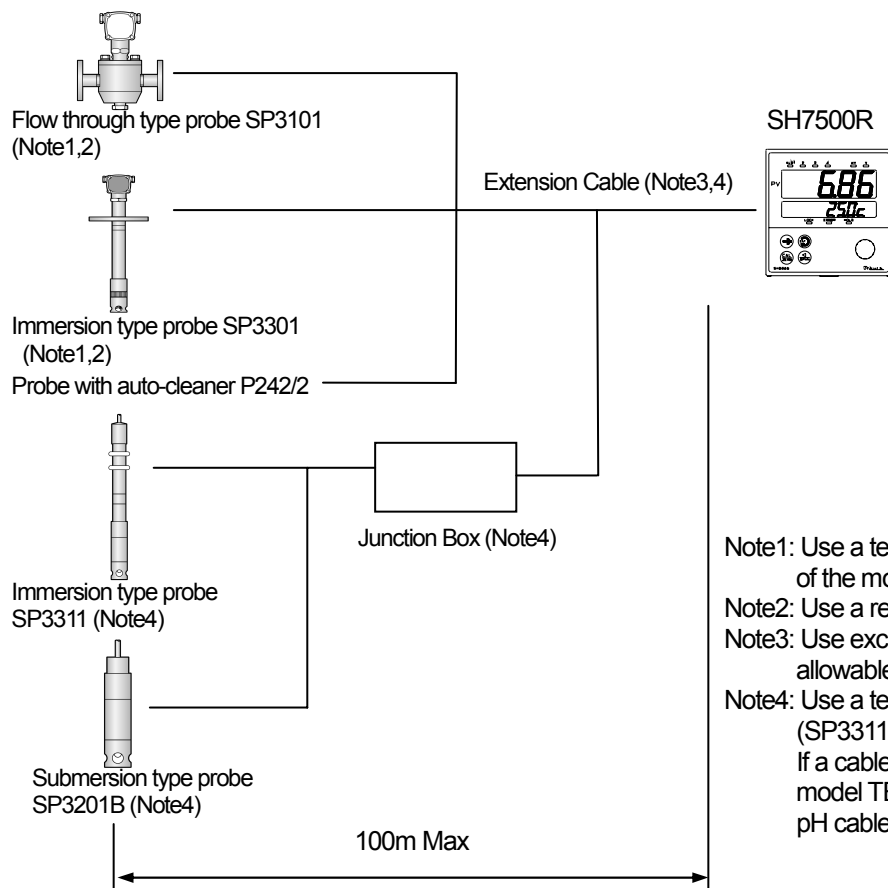

- Note1: Use a temperature compensation electrode of the model TC6000 (Pt1000)
- Note2: Use a reference electrode of the model NR3300
- Note3: Use exclusive pH cable model P301/2, allowable length 100m max.
- Note4: Use a temperature element Pt1000 type probe (SP3311A9x or SP3201Bx)
If a cable of probe is not enough, use junction box model TB1001 and exclusive pH cable model P301/2, allowable length 100m max.

DIMENSIONS

(Unit: mm)

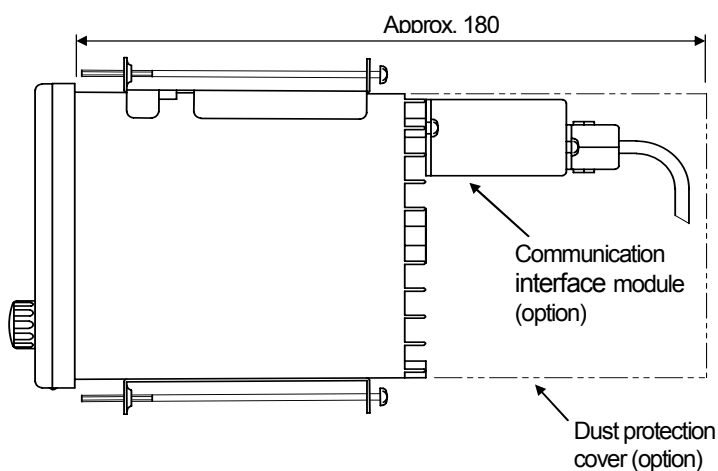
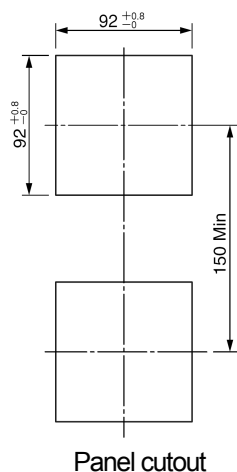
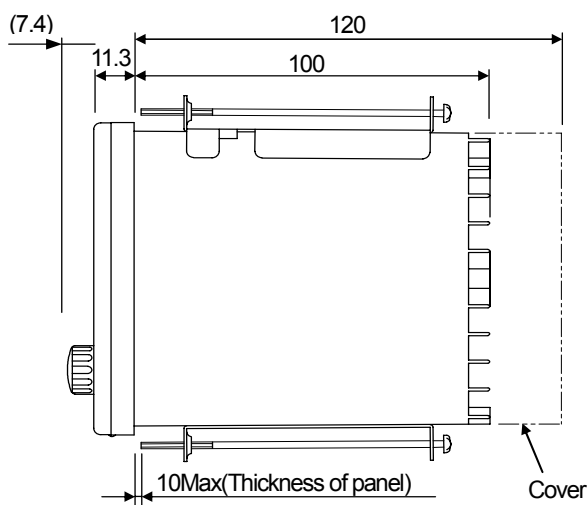
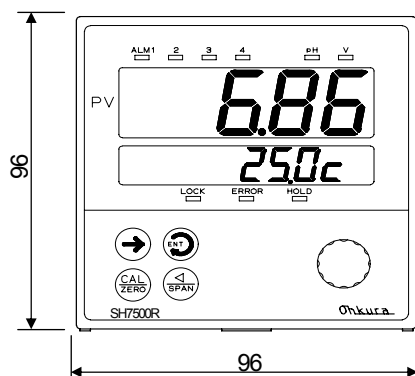

TERMINAL ARRANGEMENT

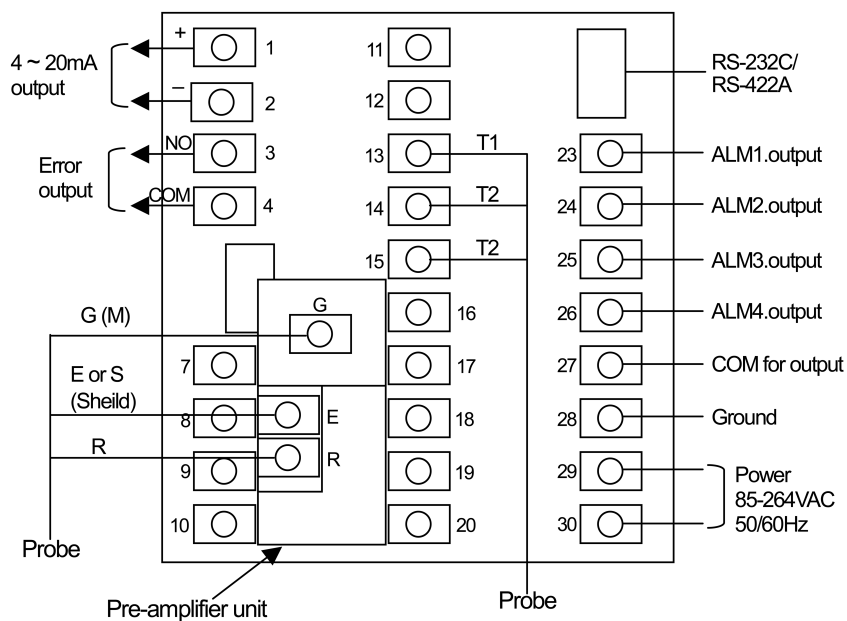

Pre-amplifier unit is installed using terminal 16 ~ 20, 7, and 10.

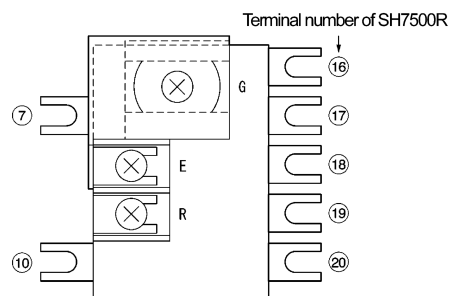

Note: All of terminals have electrical connection inside.

MODEL CODE NUMBER

MODEL	DESCRIPTION	
SH75	Digital pH(ORP) analyzer	
	CODE	INPUT
	01R	Glass electrode
	02R	ORP electrode
	03R	Antimony electrode
	CODE	COMMUNICATION MODULE
	0	No communication module
	1	RS232C communication interface module (ZE7101A0106) included
	2	RS422A communication interface module (ZE7101A0206) included
	CODE	INTERRUPTER
	0	No interrupter
	1	Installed
	CODE	TEMPERATURE COMPENSATION
	0	Standard
	CODE	OPTIONAL ACCESSORIES
	0	None
	1	Dust protection cover, terminal

COMMUNICATION INTERFACE MODDULE

ZE7101A0106: RS-232C Communication interface module, Cable HMSU2255B02, length=2m with D-sub connector

ZE7101A0206: RS-422A Communication interface module, Cable HMSU2691B01, length & number of ports to be specified

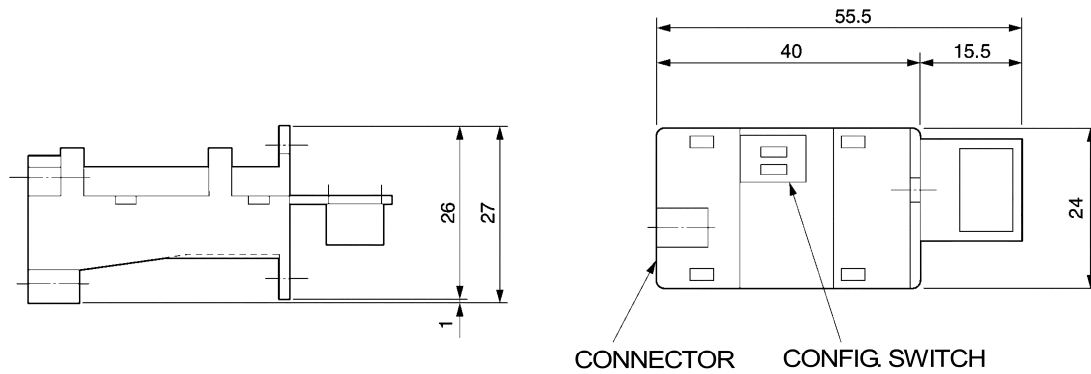

PRE-AMPLIFIER UNIT (P/N HMSU3186A01)

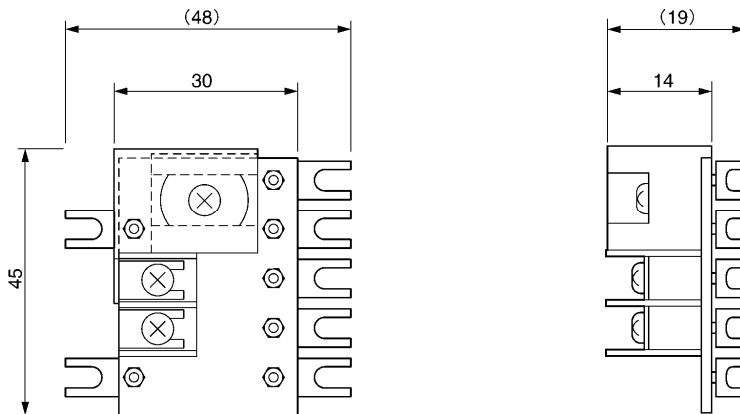

JUNCTION BOX (TYPE TB1001)

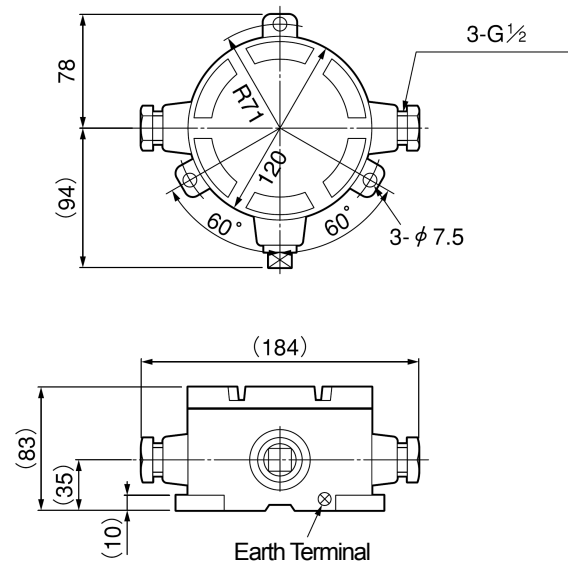

⚠ CAUTION

Do not install this device before consulting instruction manual

Ohkura

OHKURA ELECTRIC CO., LTD.

Head Office / Factory

Sales Offices

URL

e-mail (in English)

Saitama, JAPAN

Tokyo, Osaka, Nagoya, Kyushu

<http://www.ohkura.co.jp/>

contact_e@ohkura.co.jp

Specifications are subject to change without notice.

For further information, a quotation or a demonstration please contact to: